

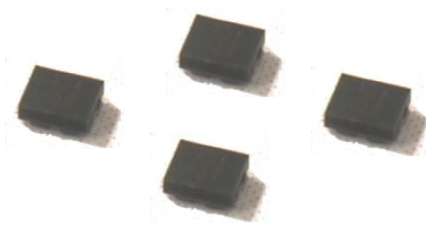

Data Sheet of SAW Components



Note : Murata SAW Component is applicable for Cellular /Cordless phone (Terminal) relevant market only.

Please also read caution at the end of this document.

SAW FILTER FOR CDMA2000 BC6 (Rx)

Murata part number : SAFEB2G12FB0F00

Package Dimensions

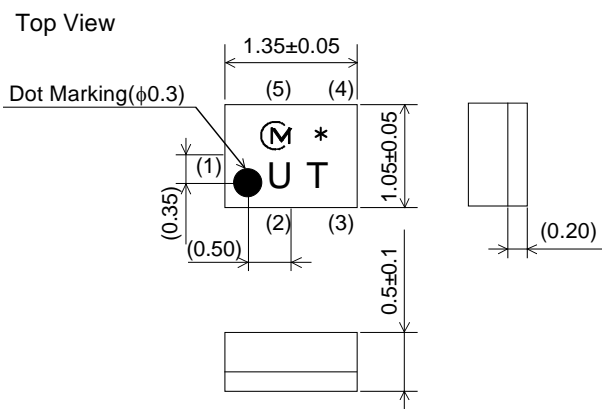

Bottom View

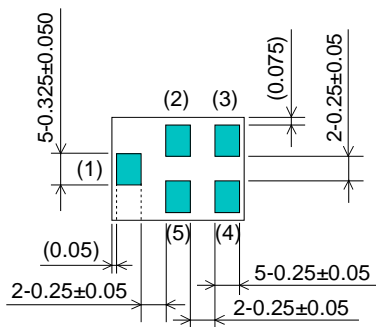

Marking
: Laser Printing

(1) : Unbalance Port
(3)(4) : Balance Port
Others : Ground

Unit : mm

Specification

Item	Specification		
	-30 to 85°C	25±2°C	typ.
Nominal Center Frequency(fc)	2120MHz		
Insertion Loss (2110 to 2130MHz)	2.0 dB max.	2.0 dB max.	1.7 dB
Absolute Attenuation			
1) 10 to 800 MHz	35 dB min.	35 dB min.	48 dB
2) 843 to 870 MHz	30 dB min.	30 dB min.	46 dB
3) 1920 to 1940 MHz	40 dB min.	40 dB min.	52 dB
4) 3000 to 6000 MHz	30 dB min.	30 dB min.	36 dB
Ripple Deviation (2110 to 2130MHz)	0.8 dB max.	0.8 dB max.	0.2 dB
VSWR (2110 to 2130MHz)	2.0 max.	2.0 max.	1.5
Amplitude Balance (2110 to 2130MHz)	±1.0dB max.	±1.0dB max.	+0.7dB
Phase Balance (2110 to 2130MHz)	180±10deg. max.	180±10deg. max.	180+4deg.
Unbalance Port Matching Impedance (nominal)	50Ω		
Balance Port Matching Impedance (nominal)	100Ω		
Input Signal Level	20mW (+13dBm), 2000 hours		

SAW FILTER FOR CDMA2000 BC6 (Rx)

Murata part number : SAFEB2G12FB0F00

Frequency Performance

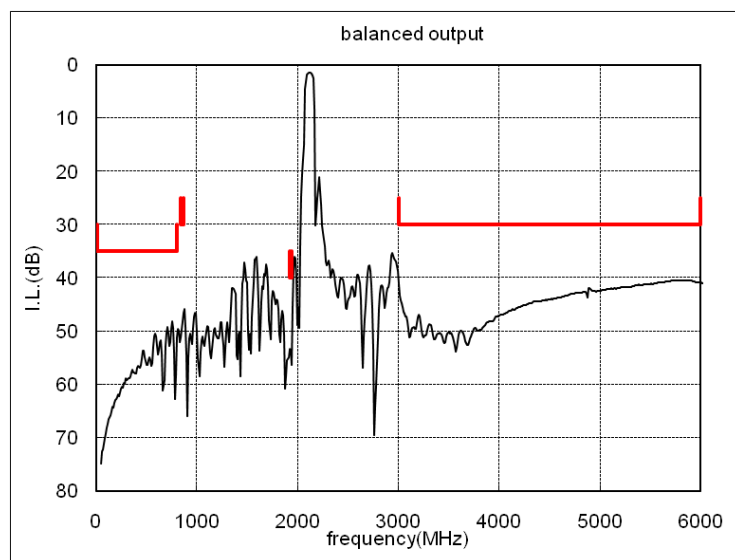
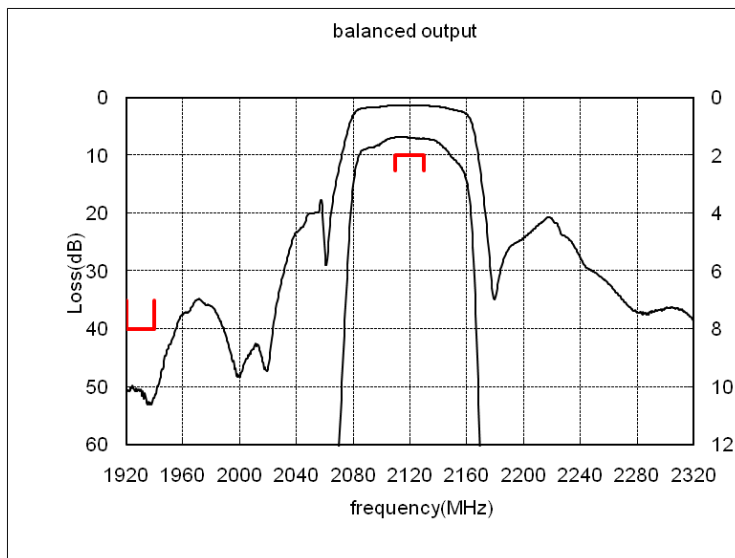

Amplitude balance

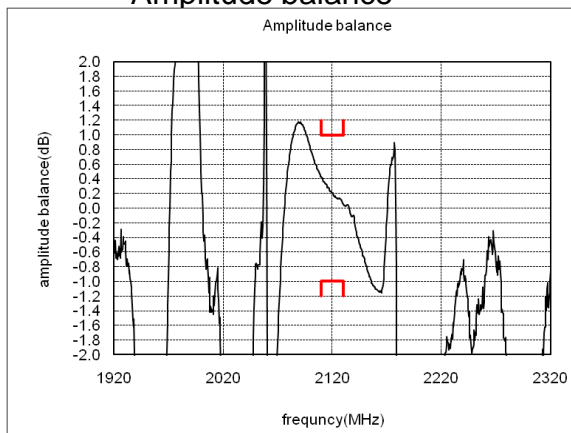

Phase balance

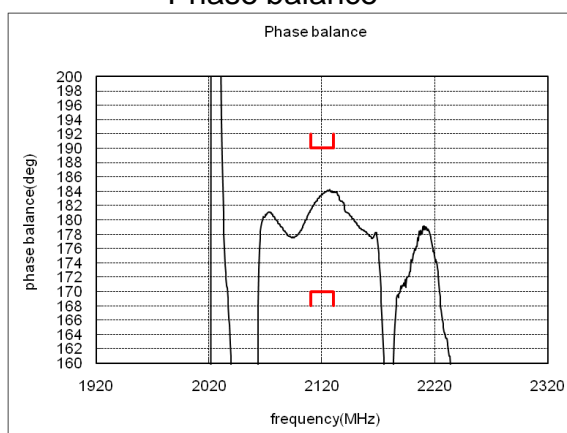

SAW FILTER FOR CDMA2000 BC6 (Rx)

Murata part number : SAFEB2G12FB0F00

Dimensions of Carrier Tape

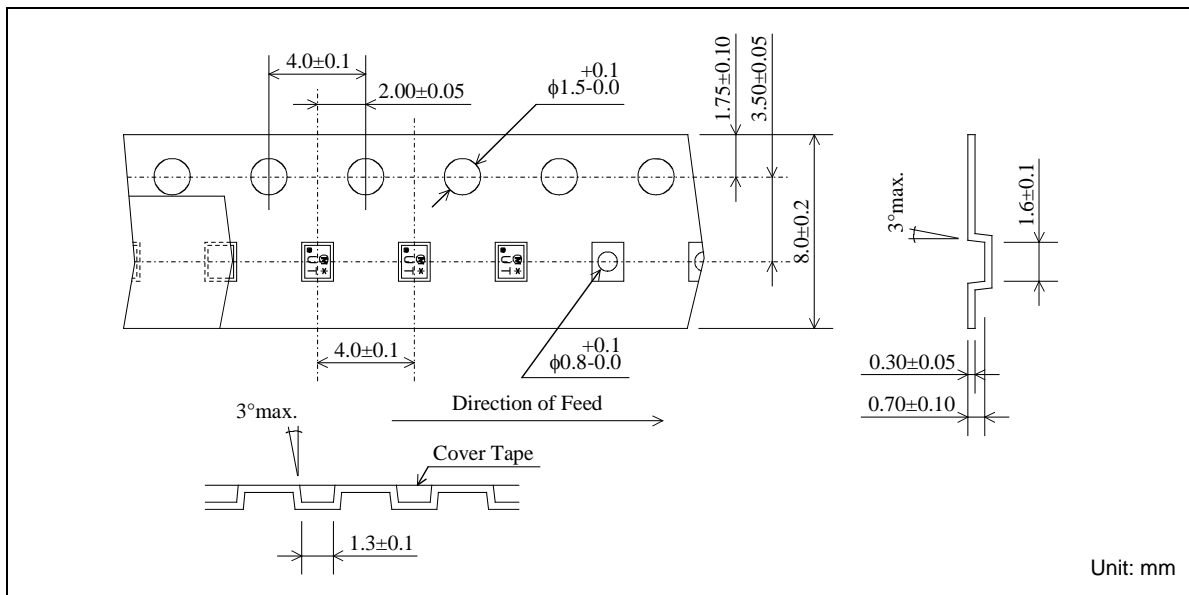

Dimensions of Tape

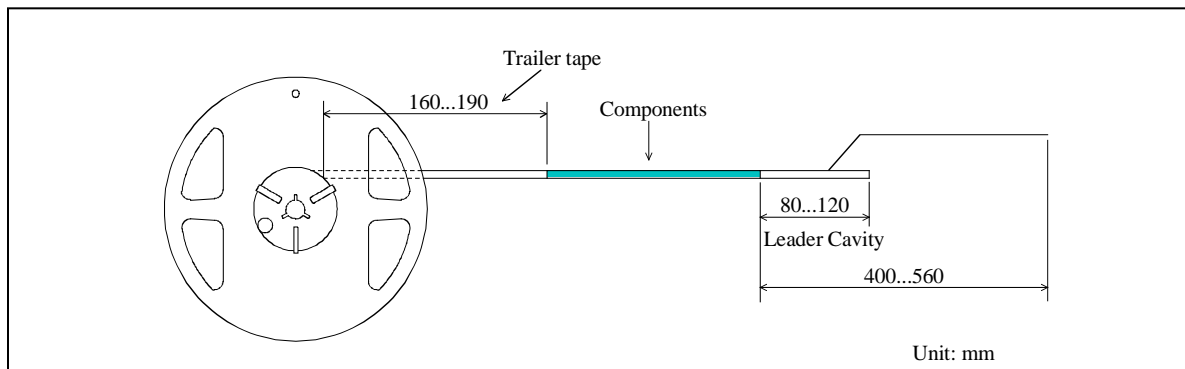

Dimensions of Reel

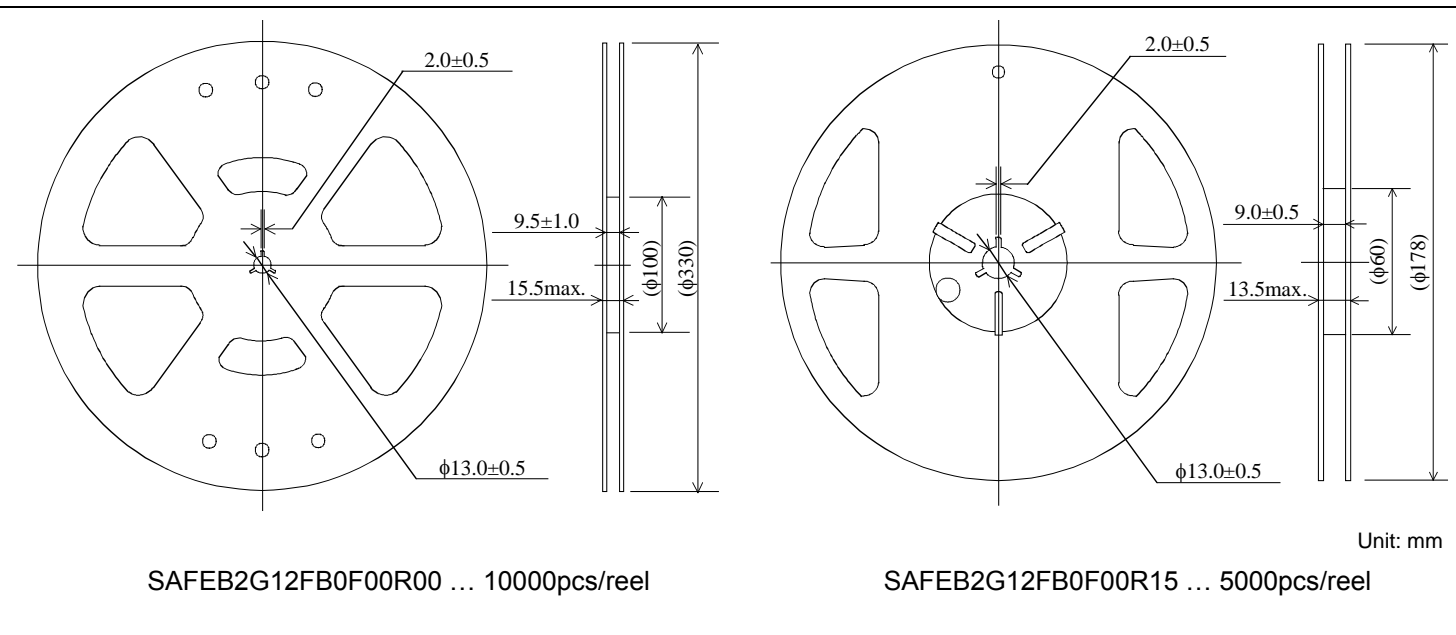

SAW FILTER FOR CDMA2000 BC6 (Rx)

Murata part number : SAFEB2G12FB0F00

Recommended Land Pattern

Top View

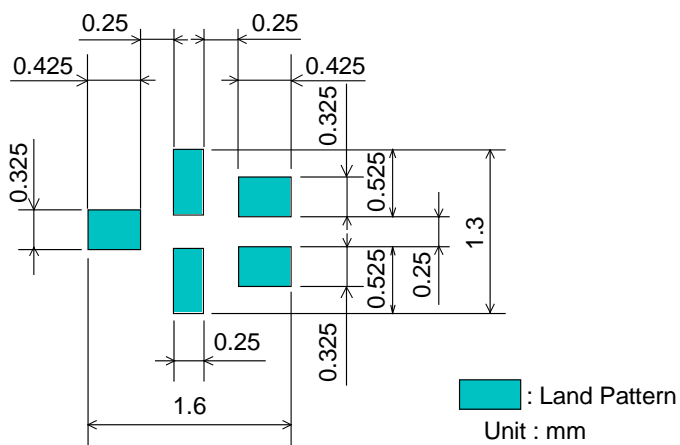

Test Circuit

Bottom View

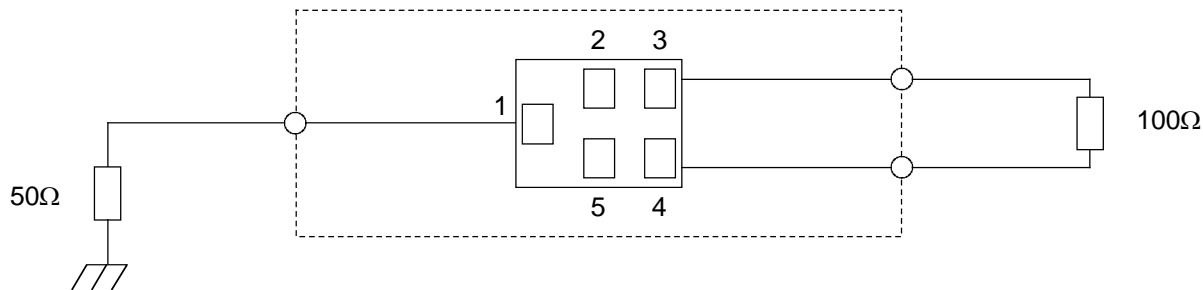

SAW FILTER FOR CDMA2000 BC6 (Rx)

Murata part number : SAFEB2G12FB0F00

■ RoHS Compliance

This component is compliant with RoHS directive.

This component was always RoHS compliant from the first date of manufacture.

• Caution - Limitation of Applications

This product is intended for the following applications only; however, please do not use this product in these applications where defects might directly cause damage to a third party's life, body or property.

- a. Mobile Telephone
- b. Cordless phone (except for Automotive use)
- c. PC (Including Notebook PC, Netbook PC, Tablet)
- d. Game
- e. Camera (except for Business/security use)
- f. Set Top Box
- g. Electronic dictionary
- h. Digital audio equipment

• This catalog is for reference only and not an official product specification document, therefore, please review and approve our official product specification before ordering this product.