



Data Sheet of SAW Components



Note : Murata SAW Component is applicable for Cellular /Cordless phone (Terminal) relevant market only.

Please also read caution at the end of this document.

SAW FILTER FOR CDMA2000 BC6 Rx

Murata part number : SAFEA2G12AL0F00

Package Dimensions

Specification

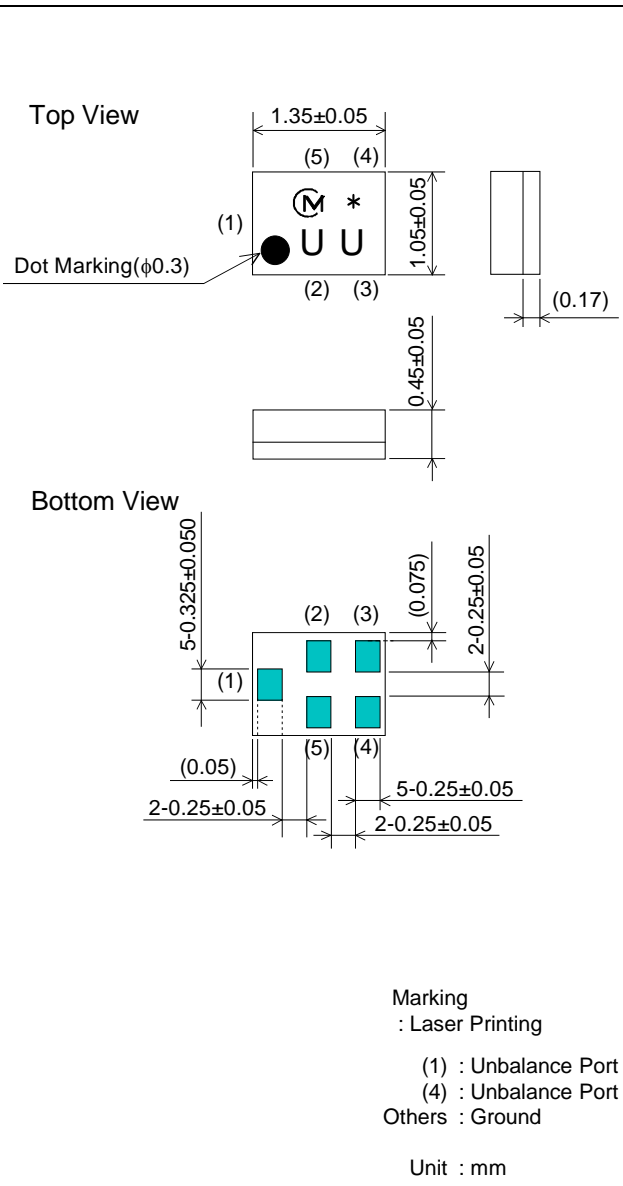

Item	Specification		
	-30 to 85°C	25±2°C	typ.
Nominal Center Frequency(fc)	2120MHz		
Insertion Loss (2110 to 2130MHz)	2.5 dB max.	2.4 dB max.	2.2 dB
Absolute Attenuation			
1) 0 to 824 MHz	45 dB min.	45 dB min.	58 dB
2) 824 to 898 MHz	50 dB min.	50 dB min.	59 dB
3) 898 to 925 MHz	50 dB min.	52 dB min.	60 dB
4) 925 to 1890 MHz	40 dB min.	40 dB min.	49 dB
5) 1890 to 1920 MHz	40 dB min.	40 dB min.	48 dB
6) 1920 to 1940 MHz	43 dB min.	43 dB min.	49 dB
7) 1940 to 1980 MHz	40 dB min.	40 dB min.	47 dB
8) 1980 to 2025 MHz	37 dB min.	37 dB min.	48 dB
9) 2025 to 2050 MHz	35 dB min.	35 dB min.	41 dB
10) 2050 to 2095 MHz	1.5 dB min.	1.5 dB min.	2.6 dB
11) 2185 to 2230 MHz	2 dB min.	2 dB min.	13 dB
12) 2230 to 2255 MHz	25 dB min.	25 dB min.	44 dB
13) 2400 to 2500 MHz	35 dB min.	35.5 dB min.	43 dB
14) 2500 to 4220 MHz	30 dB min.	30 dB min.	36 dB
15) 4220 to 4340 MHz	25 dB min.	25 dB min.	36 dB
Ripple Deviation (2110 to 2130MHz)	1.0dB max.	1.0dB max.	0.2 dB
VSWR (2110 to 2130MHz)	1.6 max.	1.5 max.	1.3
Unbalance Port Matching Impedance (nominal)	50Ω		
Input Signal Level	20mW (+13dBm), 2000 hours		

SAW FILTER FOR CDMA2000 BC6 Rx

Murata part number : SAFEA2G12AL0F00

Frequency Performance

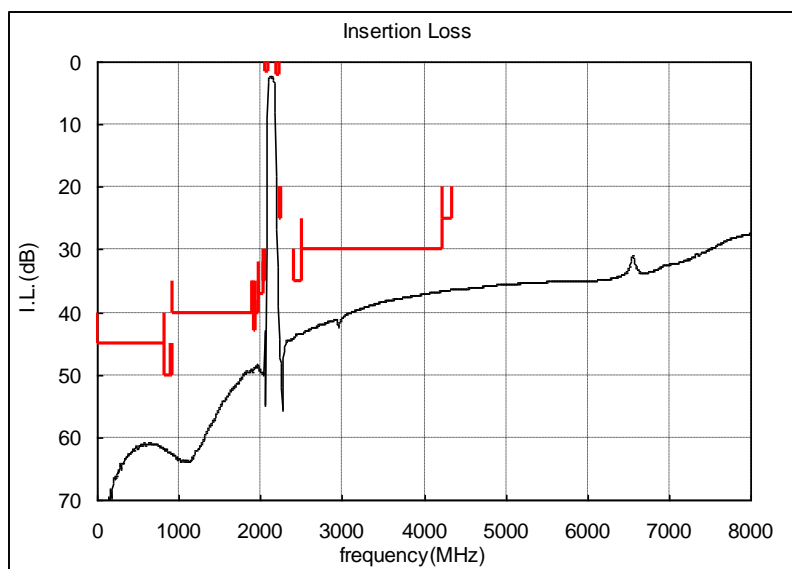
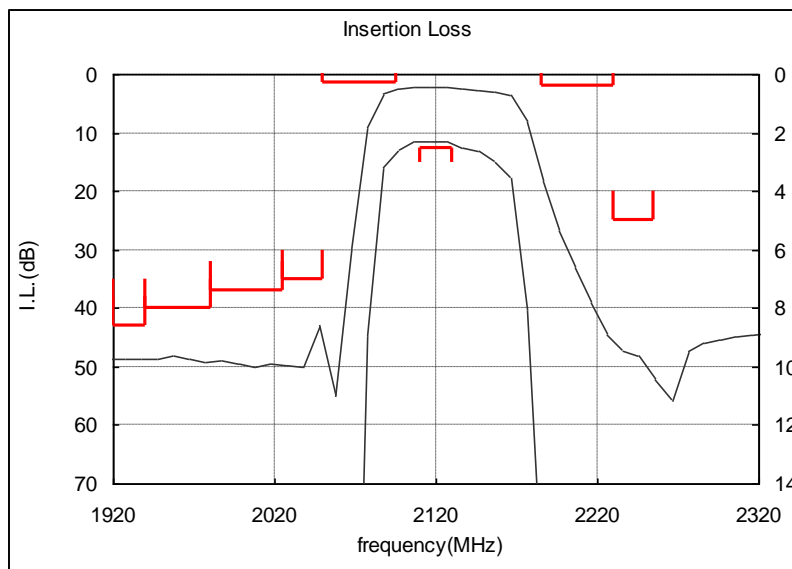

SAW FILTER FOR CDMA2000 BC6 Rx

Murata part number : SAFEA2G12AL0F00

Dimensions of Carrier Tape

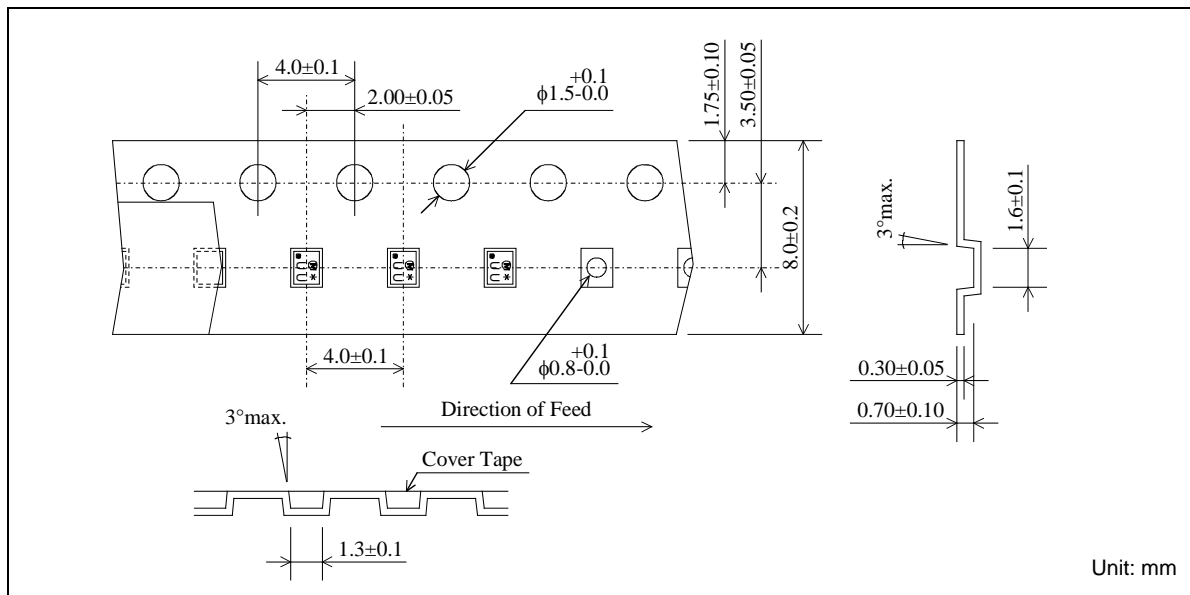

Dimensions of Tape

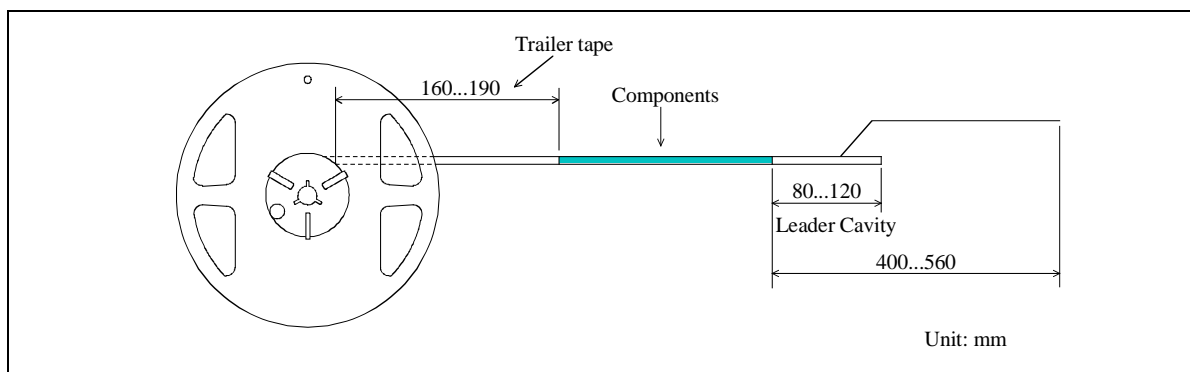

Dimensions of Reel

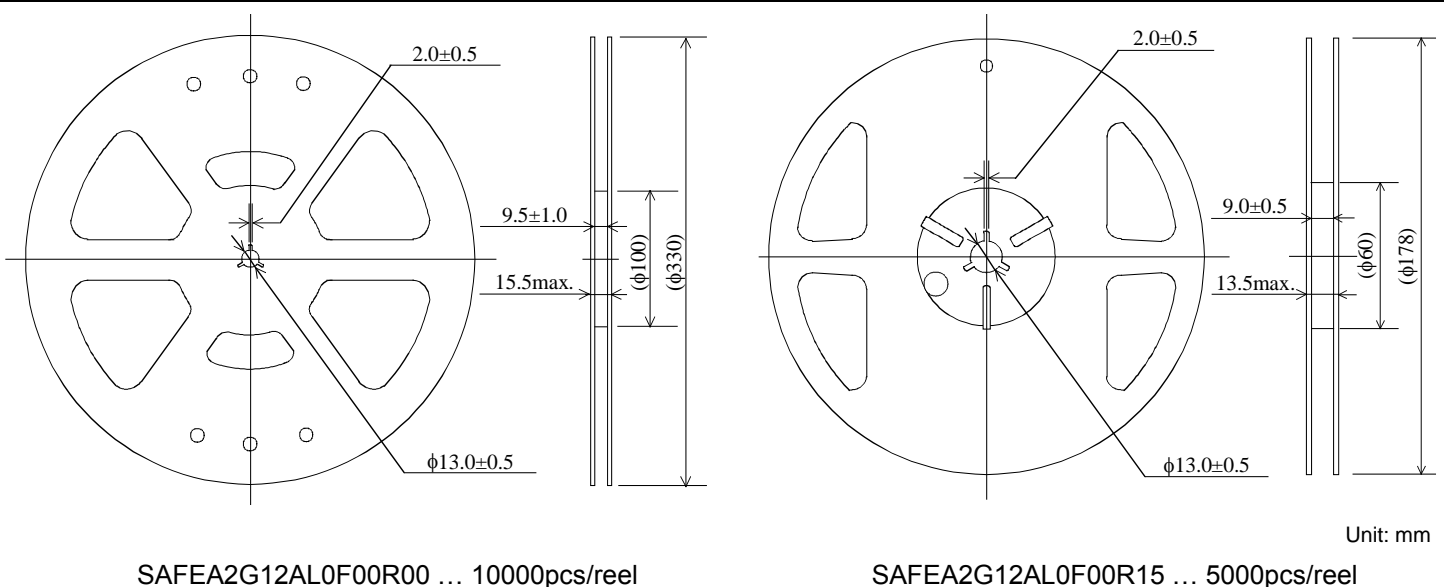

SAFEA2G12AL0F00R00 ... 10000pcs/reel

SAFEA2G12AL0F00R15 ... 5000pcs/reel

SAW FILTER FOR CDMA2000 BC6 Rx

Murata part number : SAFEA2G12AL0F00

Recommended Land Pattern

Top View

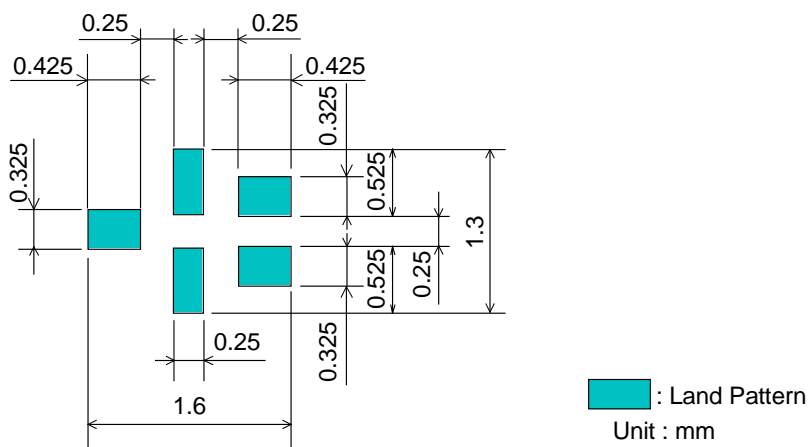

Test Circuit

Bottom View

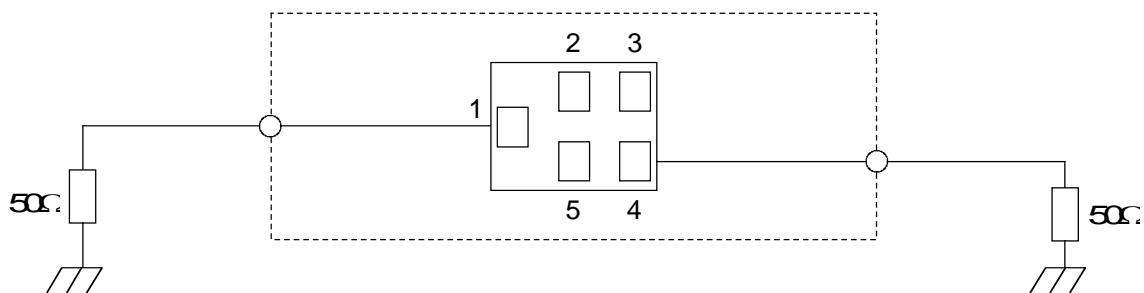

SAW FILTER FOR CDMA2000 BC6 Rx

Murata part number : SAFEA2G12AL0F00

■ RoHS Compliance

This component is compliant with RoHS directive.

This component was always RoHS compliant from the first date of manufacture.

• Caution - Limitation of Applications

This product is intended for the following applications only; however, please do not use this product in these applications where defects might directly cause damage to a third party's life, body or property.

- a. Mobile Telephone
- b. Cordless phone (except for Automotive use)
- c. PC (Including Notebook PC, Netbook PC, Tablet)
- d. Game
- e. Camera (except for Business/security use)
- f. Set Top Box
- g. Electronic dictionary
- h. Digital audio equipment

• This catalog is for reference only and not an official product specification document, therefore, please review and approve our official product specification before ordering this product.